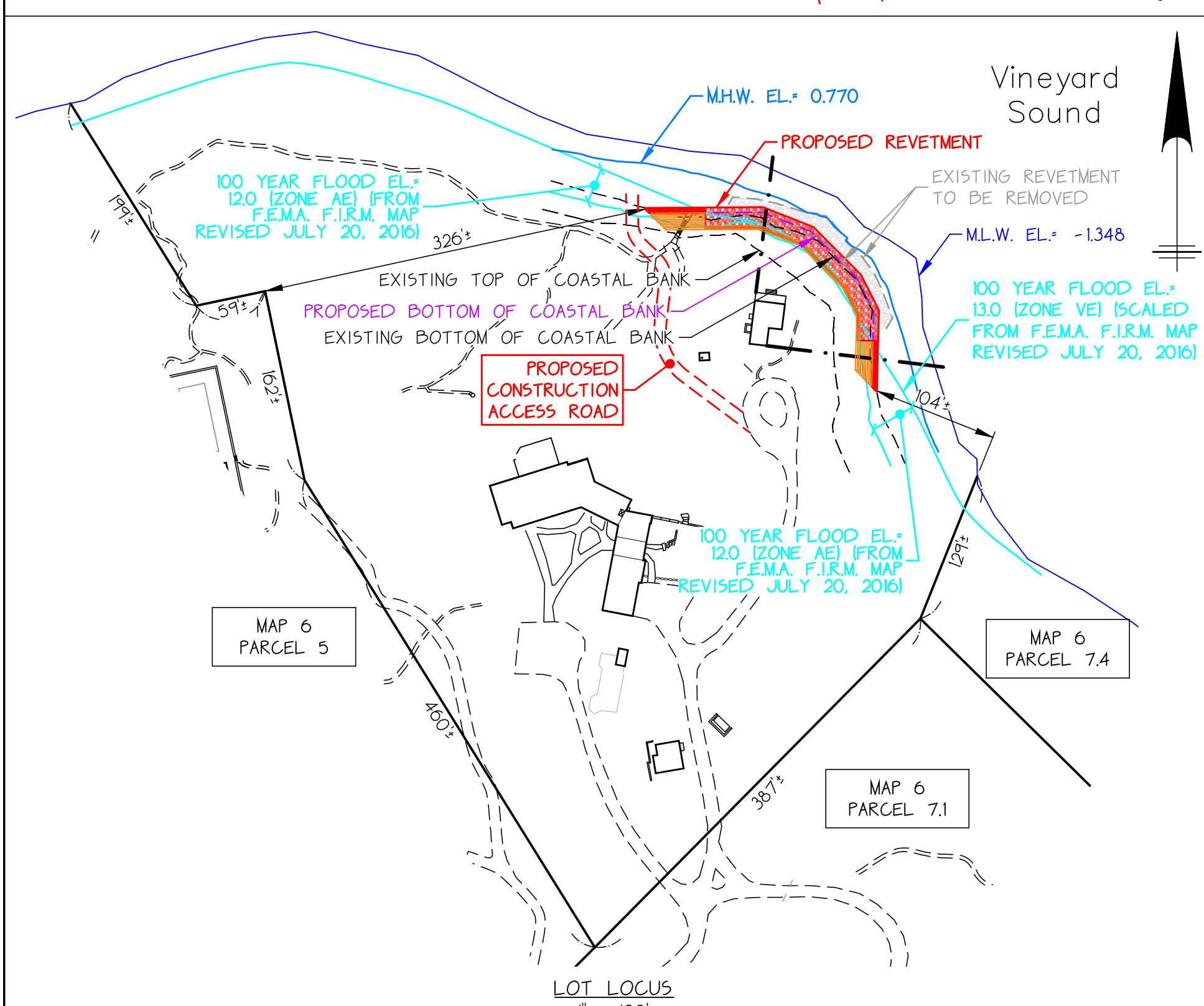
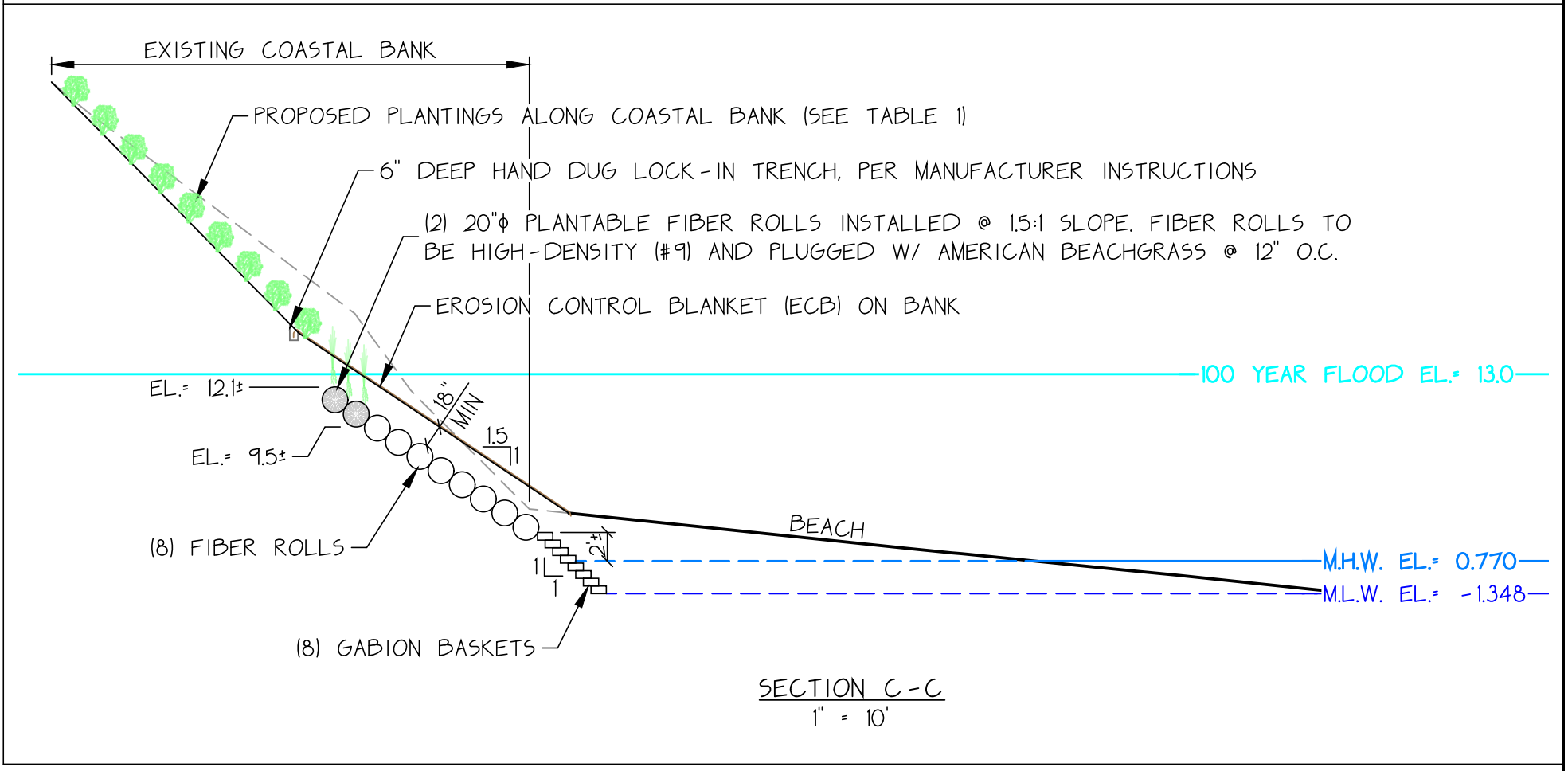
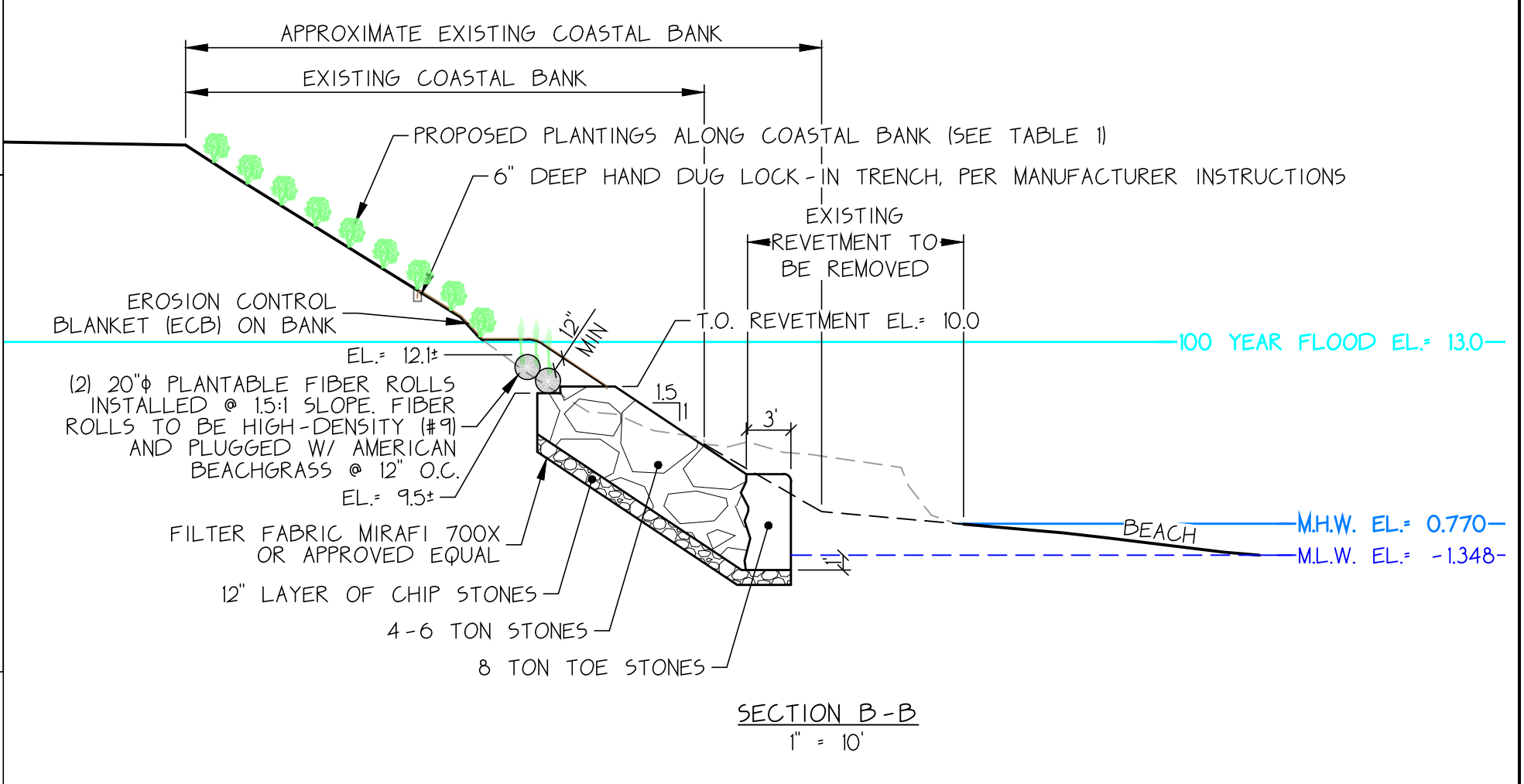
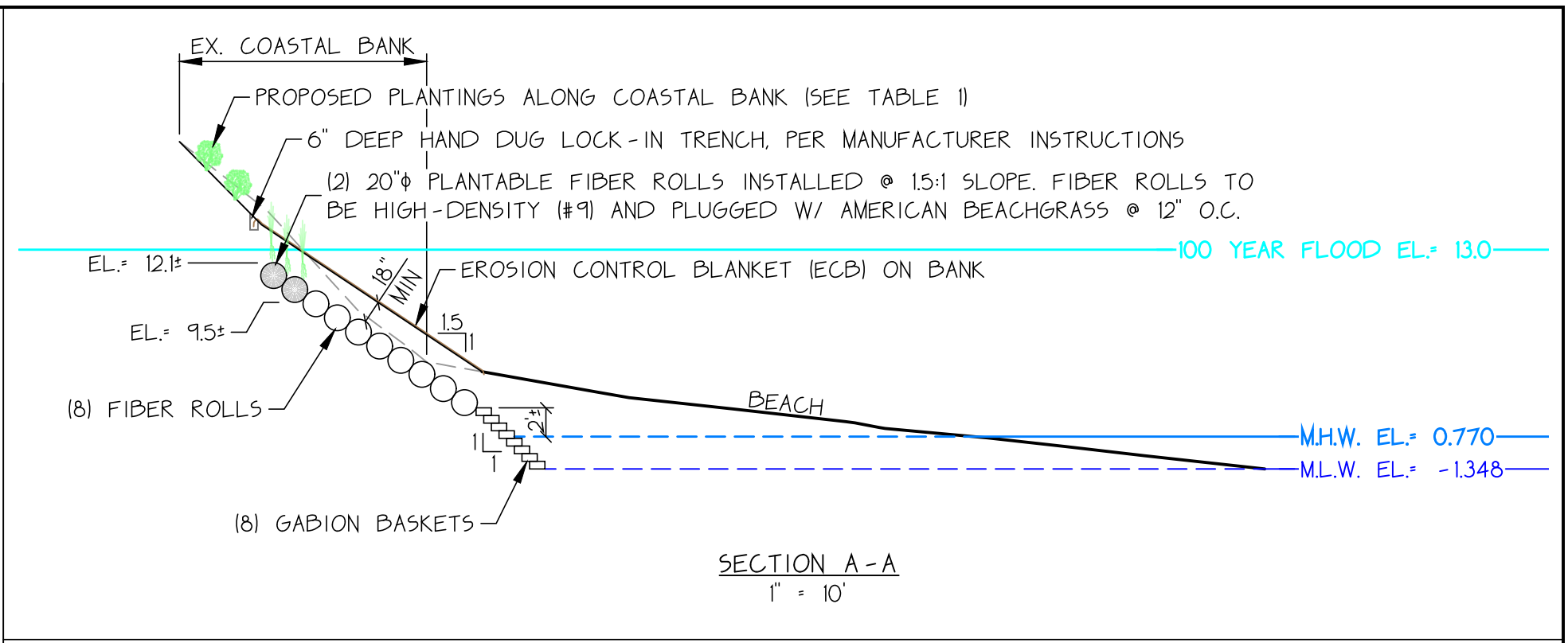

TABLE 1: PLANTS LIST

PLANTINGS SHALL CONSIST OF THE FOLLOWING GRASSES AND FORBS PLANTED AS 5" FLUGS AT 12" ON-CENTER (IN GROUND) AND 6"-9" O.C. (IN FIBER ROLLS)

COMMON NAME	SCIENTIFIC NAME
AMERICAN BEACHGRASS	L. AMMOPHILA BREVILIGULATA
SALT MEADOW HAY	L. SPARTINA PATENS
POVERTY GRASS	L. DANTHONIA SPICATA
CRINKLED HAIR GRASS	L. DESCHAMPSIA FLEXUOSA
PURPLE LOVE GRASS	L. ERAGROSTIS SPECTABILIS
SWITCHGRASS	L. PANICUM VIRGATUM
LITTLE BLUESTEM	L. SCHIZACHYRIUM SCOPARIUM
SEASIDE GOLDENROD	L. SOLIDAGO SEMPERVIRENS
(L = LOCAL GENOTYPE)	



NOTES
 1. LOT AREA: 7.6+ ACRES.
 2. DATUM: NAVD 1988.

*Conservation Commission Shore Protection Plan
 in
 West Tisbury, Massachusetts
 Assessor Parcel 6-6
 prepared for
 Cove Property*

Scale: As shown
 January 17, 2023
 Revision Date January 15, 2024
 Revision Date January 17, 2024

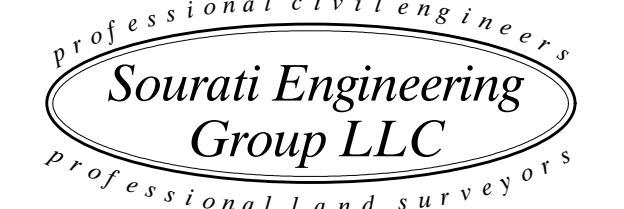

P.O. Box 4458
 107 Beach Road, Suite 202
 Vineyard Haven, MA 02568
 Phone (508) 693-9933 Fax (508) 693-4933