

Asr. Pcl. 35-1-1
Jeffrey Manter

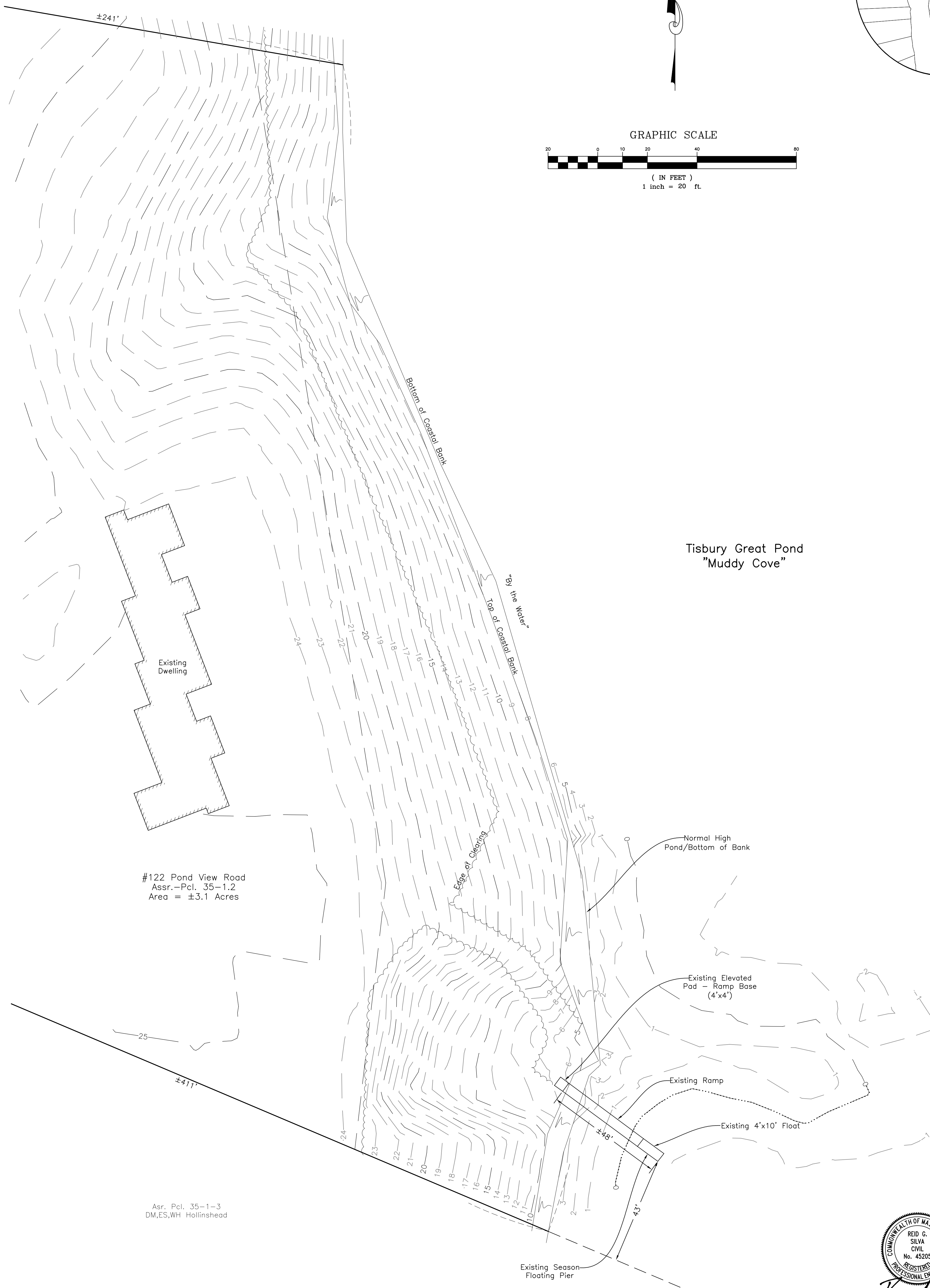
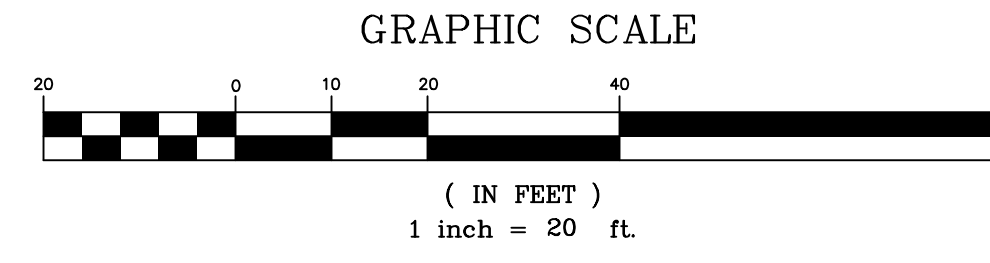
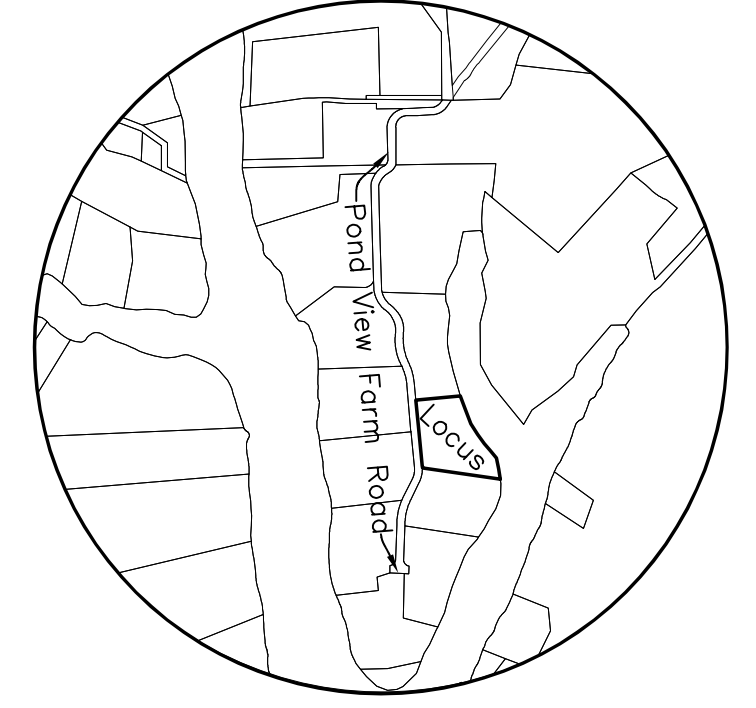

Tisbury Great Pond
"Muddy Cove"

#122 Pond View Road
Assr.-Pcl. 35-1.2
Area = ±3.1 Acres

Asr. Pcl. 35-1-3
DM,ES,WH Hollinshead

REID G. SILVA
CIVIL
No. 45205
REGISTERED
PROFESSIONAL ENGINEER
Reid G. Silva
August 30, 2022

Pier As-Built Plan in
West Tisbury, Mass.
Prepared for
Sherri Wexler
Scale 1" = 20'
August 24, 2022

VINEYARD
LAND SURVEYING
& ENGINEERING
12 Cournoyer Road
P.O. Box 421
West Tisbury, MA 02575
P 508-693-3774 | F 508-629-0440
VLSE.net