

20 Rock Pond Road
remainder of Assessor's Parcel 10-200
(Island Cohousing Community Association, Inc)

0 Stoney Hill Road
Assessor's Parcel 10-201.5
(Lynn G. Silva & James A. Richards)

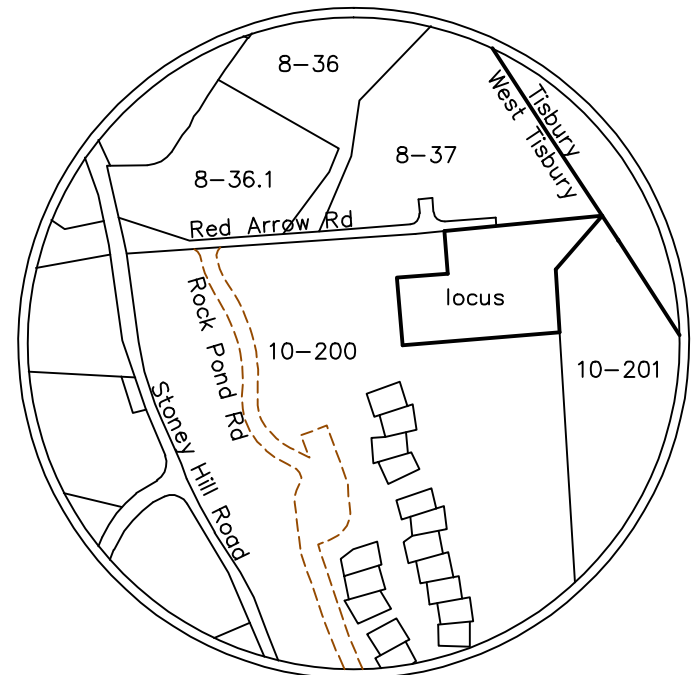

Locus Map (no scale)

Notes:

1. Locus lies within the West Tisbury RU Zoning District
 minimum lot size: 3 acres
 required property line setbacks: 50' front, 50' side, and 50' rear
 height limit: 30' above Average Natural Grade (ANG)

Site Plan
West Tisbury, Mass.
 Prepared For
Red Arrow Road Community Housing
 Scale: 1" = 40' October 27, 2022
Schofield, Barbini & Hoehn Inc.
 Land Surveying & Civil Engineering
 12 Surveyor's Lane, Box 339
 Vineyard Haven, Mass. 02568
 508-693-2781
 www.sbhinc.net
 MV 5435 (WTPB, WTZBA, building permit)