

"Nelson Tuck"  
Book 1213 Page 401  
(Asr. Pcl. 11-116)

CB found  
stockade fence  
Area of Cross-Claim  
(see plan reference #2)  
record CB

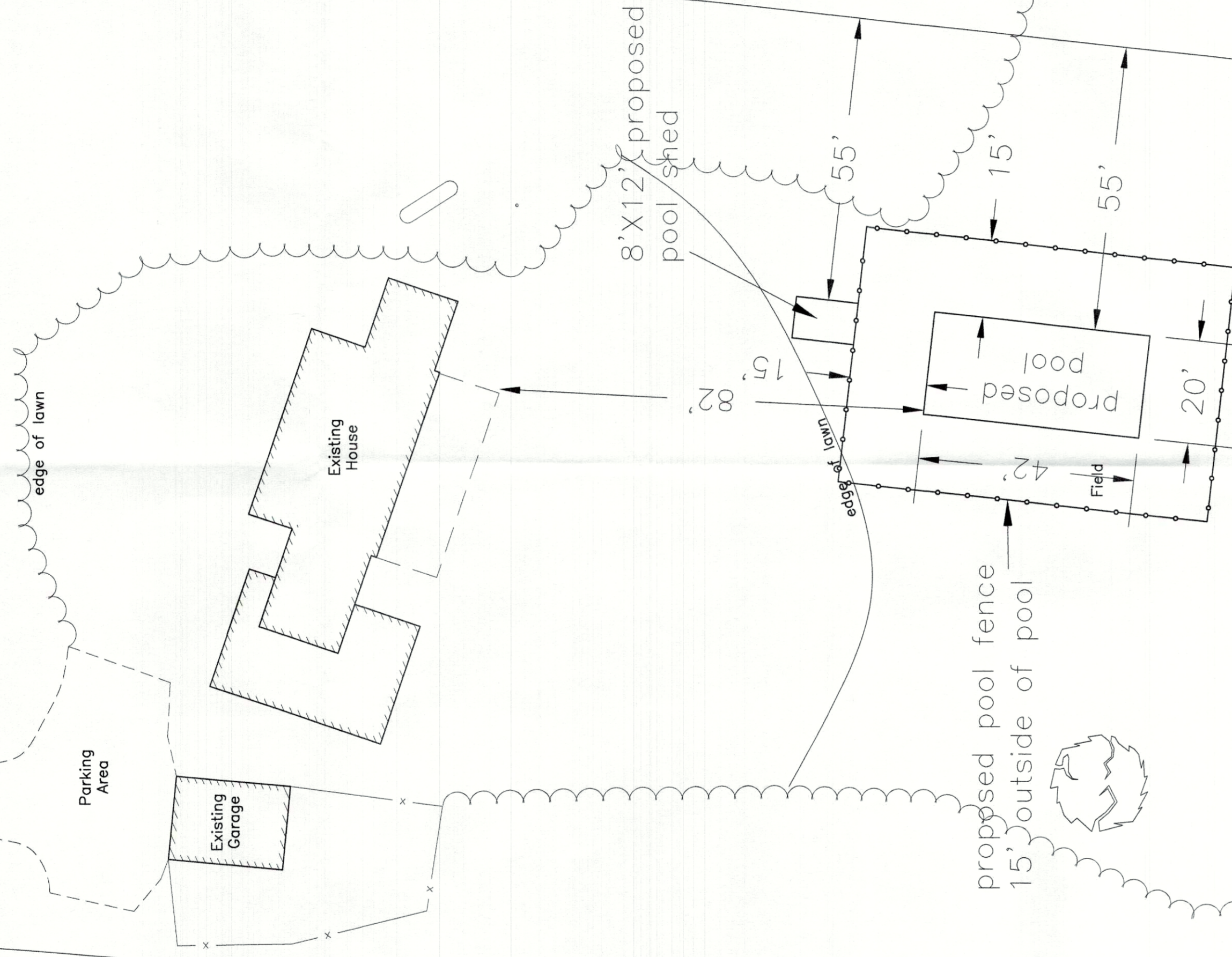
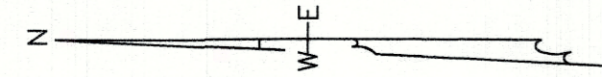

(Asr. Pcl. 11-116)

(Asr. Pcl. 11-26)

"John F. Hoff"  
Book 909 Page 593  
43 Dolphin, Merry Road  
Asr.-Pcl. 11-27  
Area = 2.58± acres  
(see plan reference #1)

PLAN REFERENCES:

1. Plan of Land in West Tisbury, Mass. Surveyed for Dr. Harold S. Stamm, Sept 5, 1970 revised May 22, 1973 By Henry R. Anderson Book 310 Page 513
2. Plan of Land in West Tisbury, Mass Prepared for Joseph Williamson: Executrix, November 30, 1976 By Schofield Brothers, Inc Case File 114

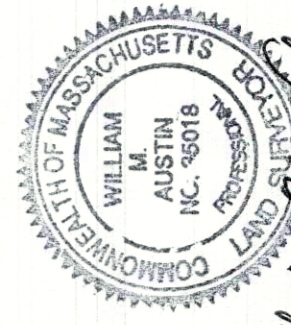

*William M. Cloutier*  
March 15, 2022

Site Plan in  
West Tisbury, Mass.  
Prepared for  
John Hoff

Scale 1" = 20'  
June 19, 2014

Revised March 15, 2022  
(show proposed pool & fence)

(Asr. Pcl. 11-117)

(Asr. Pcl. 11-22)

(Asr. Pcl. 11-21)

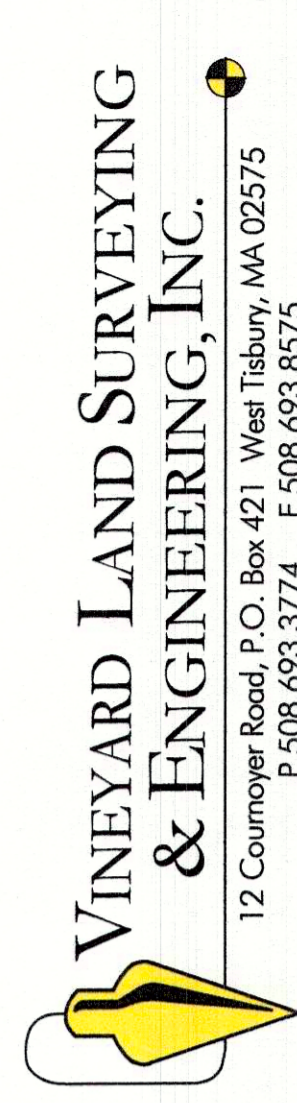

VINEYARD LAND SURVEYING  
& ENGINEERING, INC.  
12 Courtoyer Road, P.O. Box 421 West Tisbury, MA 02575  
P. 508.693.3774 F. 508.693.8575