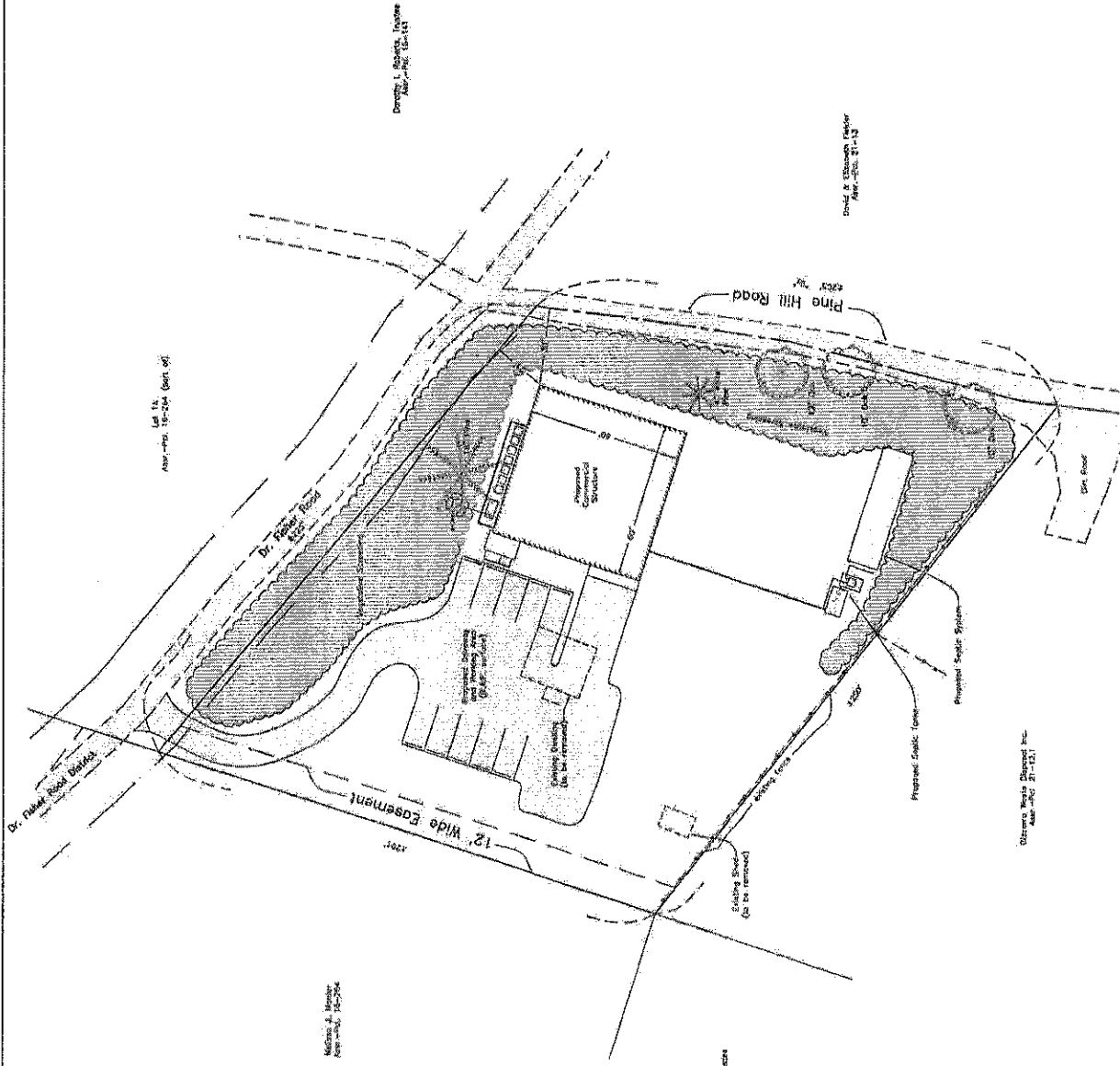
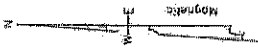

Exhibit A
Site Plans

1
d



Lot 12,
Assess. 19-264 (Part off)

Donald J. Roberts, Engineer
Assess. No. 19-141

David R. Chapman, Engineer
Assess. No. 21-13

Madison J. Mander
Assess. No. 19-264

Joseph A. Roberts, Engineer
Assess. No. 21-13

Olivero Wicks Dampp Inc.
Assess. No. 21-13, 11

Suggest:
1. Vegetative screening to consist of planting
a row of trees and shrubs along the
Driveway and parking areas within the building
setback. Screening, car parking areas will be
supplemented with buffer plantings
and etc.

Building lot 12 shown in this plan with the
Dukes County Registry of Deeds
in Plan Book 13 Page 137
This lot is in the Light Industrial Zoning District.
A portion of this lot is in the Dr. Fisher Road
CDPC

Site Plan in
West Tisbury, Mass.
Prepared for
James Eddy
May 24, 2017 Scale: 1 inch = 20 feet

