

PRELIMINARY ONLY- NOT FOR CONSTRUCTION

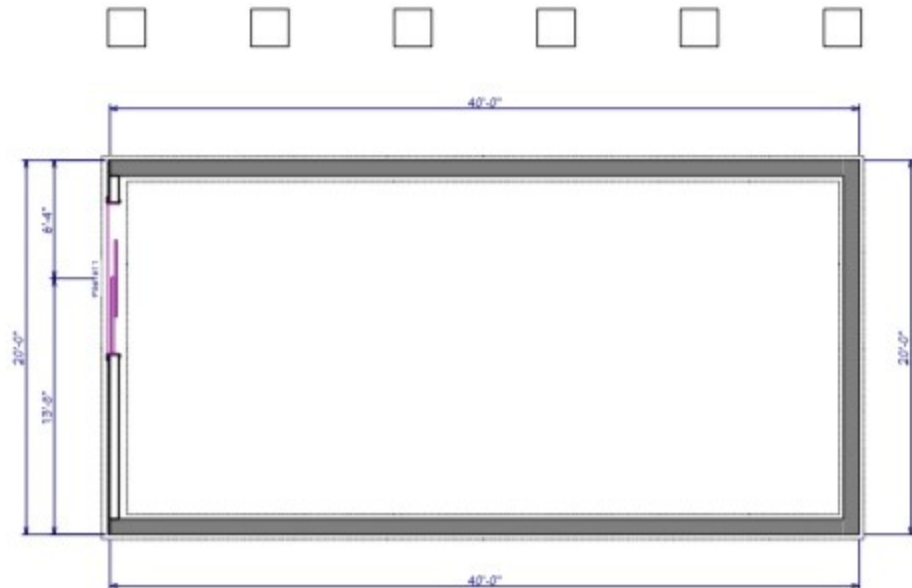

- FOUNDATION NOTES:**
- 1) THE FOUNDATION PLAN IS PROVIDED FOR FOUNDATION DESIGN PARAMETERS ONLY. COMPLETE FOUNDATION ENGINEERING BASED ON SPECIFIC SITE CONDITIONS, APPLICABLE LOCAL AND STATE CODES, TO BE REVIEWED AND APPROVED BY A REGISTERED ARCHITECT OR ENGINEER IN THE STATE OF HOUSE DESIGNATION.
 - 2) THE BUILDER/PURCHASER SHALL BE RESPONSIBLE FOR DESIGN, CONSTRUCTION AND CODE COMPLIANCE OF ALL FOUNDATION ELEMENTS INCLUDING (BUT NOT LIMITED TO) STRUCTURAL, PLUMBING, ELECTRICAL, HEATING, ENERGY CONSERVATION AND FIRE SEPARATION.
 - 3) MINIMUM COLUMN FOOTING SIZE SHALL BE 2'-0" x 2'-0" x 30" DEEP.
 - 4) CONCRETE STRENGTH TO BE A MINIMUM 3000 PSI.
 - 5) LALLY COLUMN SHALL BE MINIMUM 3 1/2" I STEEL PIPE.
 - 6) FOUNDATION SILL SHALL BE PRESERVATIVE TREATED LUMBER (SUPPLIED AND INSTALLED BY B/P PRIOR TO HOUSE DELIVERY AND SET). THERE SHALL BE NO PROTRUSION ABOVE TOP OF SILL PLATE.

SCALE: 1/4" = 1'0"

PROJECT:	R3	SUBJECT:	SQUASH MEADOW	DATE:	4/16/2020	SCALE:	AS NOTED	PAGE:	3
CONTRACTOR:	WOOD	CLIENT:	DAINE OLIMORE	PERMITS:	REGULATORY	REVISIONS:	DATE	THIRD PARTY INSPECTION AGENCY:	
DESIGNER:	DJW	ADDRESS:	311 MARCHIPSCAT TRAIL WEST Tisbury, MA	PERMITS:	REGULATORY	REVISIONS:	DATE	PERMITS:	
DATE:	4/16/2020	PROJECT:	20 X 40 GUEST COTTAGE	PERMITS:	REGULATORY	REVISIONS:	DATE	PERMITS:	
SCALE:	AS NOTED	CLIENT:	WESTCHESTER MODULAR HOMES INC.	PERMITS:	REGULATORY	REVISIONS:	DATE	PERMITS:	
PAGE:	3	ADDRESS:	30 REAGANS MILL RD. WINGDALE, NY 12294	PERMITS:	REGULATORY	REVISIONS:	DATE	PERMITS:	
		CONTACT:	Tel (845) 832-9400 Fax (845) 832-6698	PERMITS:	REGULATORY	REVISIONS:	DATE	PERMITS:	