

Edgartown - West Tisbury Road

Assr.-Pcl. 29-45.1
"N/F Timothy Alan McKay"

Existing Well

±700'

Assr.-Pcl. 29-44
"N/F Christian MacDonald"

CB set

CB set

±110'

Existing Well

Existing Driveway

60'

161'

Proposed Sport Court
(30'x52')

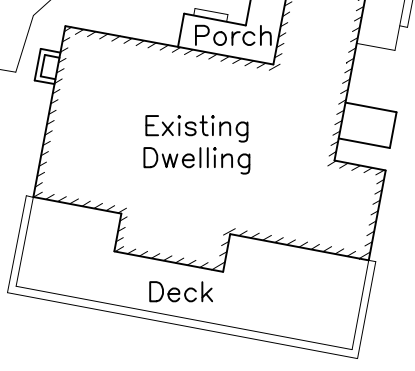

#8 Waldrons Bottom Road
Assr.-Pcl. 29-45.2
Area = 2.68 Acres

Assr.-Pcl. 29-81
"N/F Homer Watcha Trust et al"

Waldrons Bottom Road

59'

Existing Driveway

±659'

Existing Well

±248'

CB found

Assr.-Pcl. 29-46
"N/F Anthony Marchigiano"

BENCHMARK:
Concrete Bound
Elev. = 48.2

Site Plan in
West Tisbury, Mass.
Prepared for
Joseph O'Donnell
Scale 1" = 30'
August 12, 2022



VINEYARD
LAND SURVEYING
& ENGINEERING

12 Cournoyer Road
P.O. Box 421
West Tisbury, MA 02575
P 508-693-3774 F 508-629-0440
VLSE.net