

- Legend**
- EXISTING STRUCTURES TO BE RENOVATED/REBUILT
 - - - EXISTING STRUCTURES TO BE REMOVED
 - PROPOSED STRUCTURES

 Charles R. Gilstad
 2/27/24

Site Plan
 in
West Tisbury, Massachusetts
Assessor Parcel 35-6.12
 prepared for
The CYS 130 Realty Trust
 Scale 1"=30' February 27, 2024

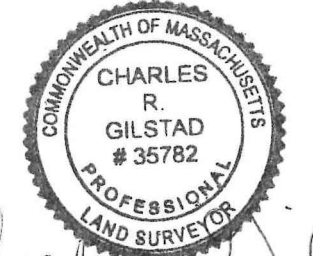
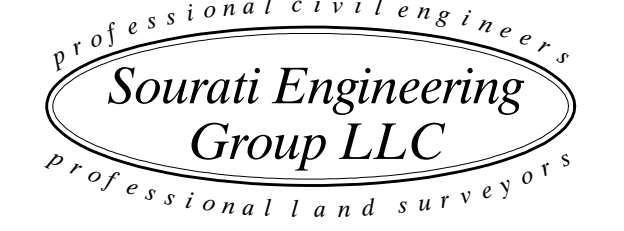

P.O. Box 4458
 107 Beach Road, Suite 202
 Vineyard Haven, MA 02568
 Phone (508) 693-9933 Fax (508) 693-4933

NOTES:
 1. APPROXIMATE LOT AREA: 4.0± ACRES.
 2. DATUM: NAVD 1988.
 3. COASTAL BANK DELINEATION TAKEN FROM COASTAL BANK ASSESSMENT PREPARED BY EPSILON ASSOCIATES, INC.