

REGULATORY NOTES

- CONTRACTOR SHALL CONTACT DIG-SAFE FOR UNDERGROUND UTILITY MARKING AT 1-888-344-7233 AT LEAST 72 HOURS PRIOR TO COMMENCEMENT OF ANY WORK.
- THE CONTRACTOR SHALL BE RESPONSIBLE FOR PROPERLY LOCATING AND COORDINATING ANY ON-SITE ACTIVITY WITH DIG-SAFE AND THE APPROPRIATE UTILITY COMPANY AND MAINTAINING EXISTING UTILITY SYSTEM SERVICE.
- CONTRACTOR SHALL MAKE THEMSELVES AWARE OF AND SHALL COMPLY WITH ALL CONSTRUCTION REQUIREMENTS, CONDITIONS, AND LIMITATIONS IMPOSED REGULATORY REQUIREMENTS, PERMITS, AND APPROVALS OF REGULATORY AUTHORITIES AND UTILITY COMPANIES PRIOR TO COMMENCEMENT OF ANY WORK. CONTRACTOR SHALL COORDINATE AND OBTAIN ALL CONSTRUCTION PERMITS, APPROVALS, INSPECTIONS, AND/OR CERTIFICATIONS REQUIRED BY REGULATORY AUTHORITIES.
- DISPOSE OF ALL CONSTRUCTION WASTE IN ACCORDANCE WITH ALL APPLICABLE LAWS AND REGULATIONS.
- WETLAND FLAGS AND FLAG NUMBERS SHALL BE SURVEYED, RE-FLAGGED IF NECESSARY, AND SHALL REMAIN IN PLACE FOR THE DURATION OF THE PROJECT. DAMAGED OR DESTROYED FLAGS SHALL BE REPLACED AND THEIR LOCATIONS INSPECTED BY A CONSERVATION COMMISSION REPRESENTATIVE. THE METHOD BY WHICH MISSING FLAGS ARE LOCATED SHALL BE SUBJECT TO THE APPROVAL OF THE COMMISSION.
- ANY DISCHARGE FROM DEWATERING OPERATIONS, SHOULD SUCH OPERATIONS PROVE NECESSARY, SHALL TAKE PLACE OUTSIDE THE 100-FOOT BUFFER ZONE TO WETLAND RESOURCE AREAS AND WITHIN THE LIMIT OF WORK. DISCHARGE FROM SEDIMENTATION BASINS SHALL BE FILTERED THROUGH SILT SACKS.
- NO MATERIALS, INCLUDING BUT NOT LIMITED TO GRAVEL, TOPSOIL, BOULDERS, BRUSH, LOGS, STUMPS, SLASH, ASPHALT, AND CONSTRUCTION SUPPLIES OR DEBRIS, SHALL BE STORED OR BURIED WITHIN THE 100-FT BORDERING VEGETATED WETLAND BUFFER ZONE, OR THE FEMA 100-YEAR FLOOD AREA. ALL SUCH MATERIALS SHALL BE REMOVED FROM THE SITE PRIOR TO COMPLETION OF THE PROJECT, EXCEPT AS APPROVED BY THE OWNER'S REPRESENTATIVE.

GENERAL NOTES

- TOPOGRAPHIC/SITE SURVEY AND LOCATIONS OF UNDERGROUND UTILITIES SOURCED FROM "EXISTING CONDITIONS" BY FARLAND CORP., DATED SEPTEMBER 30, 2022.
- EXISTING UNDERGROUND ELECTRICAL UTILITY ALIGNMENT FROM GENERATOR TO WEST TISBURY TOWN HALL (WTHH) BASED ON SITE PHOTOGRAPHY TAKEN BY WTHH STAFF ON OCTOBER 12, 2022.
- VERTICAL ELEVATIONS REFER TO THE NORTH AMERICAN VERTICAL DATUM OF 1998 (NAVD 88) AND HORIZONTAL LOCATIONS REFER TO THE NORTH AMERICAN DATUM OF 1983 (NAD 83).
- ARUP HAS NOT VERIFIED EXISTING CONDITIONS INFORMATION INDICATED HEREON. LOCATIONS OF EXISTING UNDERGROUND UTILITIES/OBSTRUCTIONS/STRUCTURES/SYSTEMS SHOWN HEREON ARE APPROXIMATE ONLY. ADDITIONAL UTILITIES/OBSTRUCTIONS/STRUCTURES/SYSTEMS NOT INDICATED HEREON MAY EXIST. EXISTING UTILITY, PROPERTY LINE, AND ENVIRONMENTAL RESOURCE AREA INFORMATION INDICATED ON THIS PLAN SHOULD BE CONSIDERED APPROXIMATE.
- NO GUARANTEE IS IMPLIED OR INTENDED AS TO THE ACCURACY, LOCATION, OR THAT ALL UTILITIES AND/OR SUBSURFACE STRUCTURES ARE SHOWN. CONTRACTOR SHALL VERIFY SIZE, LOCATION, AND ELEVATIONS OF UTILITIES AND STRUCTURES AS REQUIRED PRIOR TO THE START OF ANY CONSTRUCTION.
- EXISTING UTILITIES TO REMAIN AND BE PROTECTED DURING CONSTRUCTION UNLESS OTHERWISE NOTED. CONTRACTOR TO NOTIFY ENGINEER ABOUT ANY CONFLICTS.
- THE CONTRACTOR SHALL BE RESPONSIBLE FOR PROPERLY LOCATING AND COORDINATING ANY ON-SITE ACTIVITY WITH DIG-SAFE AND THE APPROPRIATE UTILITY COMPANY AND MAINTAINING EXISTING UTILITY SYSTEM SERVICE.
- SAFETY MEASURES, CONSTRUCTION METHODS AND CONTROL OF WORK SHALL BE RESPONSIBILITY OF CONTRACTOR.
- CONTRACTOR SHALL BE RESPONSIBLE FOR REPAIR AND/OR REPLACEMENT OF ANY EXISTING IMPROVEMENTS DAMAGED DURING DEMOLITION THAT ARE NOT DESIGNATED FOR DEMOLITION AND/OR REMOVAL ON THE CONTRACT DOCUMENTS. DAMAGED IMPROVEMENTS SHALL BE REPAIRED TO THE SATISFACTION OF THEIR RESPECTIVE OWNERS.
- ALL DISTURBED AREAS SHALL BE RESTORED TO THEIR PRE-CONSTRUCTION CONDITIONS UPON COMPLETION OF DEMOLITION WORK, UNLESS OTHERWISE NOTED ON THE CONTRACT DOCUMENTS.
- ANY DEMOLITION NECESSITATED BY FIELD CONDITIONS NOT COVERED ON THE CONTRACT DOCUMENTS SHALL BE REVIEWED AND APPROVED BY THE OWNER'S REPRESENTATIVE PRIOR TO IMPLEMENTATION.
- CONTRACTOR SHALL PROVIDE EROSION AND SEDIMENTATION CONTROL AS NEEDED TO PREVENT TRANSPORT OF SEDIMENT FROM THE WORK SITE TO PAVED SURFACES, STORM SEWERS, AND WETLANDS IN THE AREA WHETHER OR NOT SHOWN HEREON. ANY SEDIMENT TRACKED FROM THE WORK SITE ONTO PAVED SURFACES SHALL BE REMOVED BY THE CONTRACTOR AT THE END OF EACH WORK DAY.

- CONTRACTOR SHALL IDENTIFY AND PROVIDE SILTATION PROTECTION FOR ALL CATCH BASINS DOWNGRADIENT OF THE PROJECT LIMIT OF WORK.
- CONTRACTOR TO PROTECT TREES FROM DAMAGE DURING CONSTRUCTION. FOR EXCAVATIONS WITHIN THE DRIP LINE OF TREES:
 - DO NOT CUT ROOTS OVER 1 INCH IN DIAMETER WITHOUT APPROVAL OF THE ENGINEER.
 - PROTECT EXPOSED ROOTS OVER 1 INCH IN DIAMETER WITH DRY SACKING DURING EXCAVATION. REMOVE DRY SACKING BEFORE BACKFILLING, AND COMPACT BACKFILL WITH CARE AROUND THE RETAINED ROOTS.
 - PRUNE ROOTS WHICH HAVE TO BE REMOVED USING A SHARP TOOL; MAKE A CLEAN CUT AND LEAVE AS SMALL A WOUND AS POSSIBLE.
- DO NOT STORE MATERIALS, EQUIPMENT, OR STOCKPILE SOIL WITHIN THE DRIP LINE OF TREES.
- PROTECT IN PLACE OR REMOVE AND REINSTATE EXISTING WAYFINDING AND PARKING SIGNS (NOT SHOWN HEREON). COORDINATE WITH OWNERS REPRESENTATIVE.
- CONTRACTOR TO PROVIDE TEMPORARY CONSTRUCTION FENCING AND SIGNAGE. SUBMIT CONSTRUCTION PHASING, FENCING, AND SIGNAGE PLAN FOR APPROVAL.
- PROPOSED SAWCUT AREA INDICATES ANTICIPATED SURFACE REMOVAL EXTENTS. MINIMIZE REMOVAL OF EXISTING SURFACES DURING DEMOLITION AND CONSTRUCTION AND REINSTATE ALL EXISTING SURFACES IN KIND UNLESS OTHERWISE NOTED.
- PROPOSED IMPERVIOUS COVERAGE NOT TO EXCEED EXISTING CONDITIONS. IF PROPOSED IMPERVIOUS COVERAGE EXCEEDS EXISTING CONDITIONS, ADDITIONAL PERMITTING/APPROVAL AND STORMWATER DESIGN MAY BE REQUIRED.
- MATCH EXISTING GRADING TO MAXIMUM EXTENT PRACTICABLE AND MAINTAIN EXISTING DRAINAGE PATTERNS. THE PROPOSED WORK SHALL NOT CREATE ANY NEW LOW POINTS ON THE SITE
- REFER TO ELECTRICAL DRAWINGS AND SPECIFICATIONS FOR ADDITIONAL REQUIREMENTS.
- COORDINATE ALL WORK WITH ELECTRICAL CONTRACTOR AND UTILITY COMPANY.

PROPOSED WORKS LEGEND

- ELECTRICAL EQUIPMENT AND CONCRETE PAD
- EQUIPMENT CLEARANCE
- TEMPORARY SWITCHGEAR ENCLOSURE
- INDUCTIVE BUS CHARGING PADS
- PULL BOX
- TEMPORARY EQUIPMENT

EXISTING WORKS LEGEND

- PROPERTY LINE
- CONTOUR LINE
- EXISTING EDGE OF PAVEMENT
- EXISTING WATER LINE
- EXISTING GAS LINE
- EXISTING ELECTRICAL, TELEPHONE, & CABLE
- EXISTING GRAVITY SEWER
- CHAIN LINK FENCE
- WOOD FENCE
- POST AND RAIL FENCE
- WATER GATE
- SIGN
- LIGHT
- UTILITY POLE
- CATCH BASIN
- DRAIN MANHOLE
- ELECTRIC MANHOLE
- ELECTRIC HANDHOLE
- ELECTRIC METER
- ELECTRIC BOX
- TRANSFORMER
- EVERGREEN TREE (DIAMETER IN INCHES)
- DECIDUOUS TREE (DIAMETER IN INCHES)
- SPOT ELEVATION

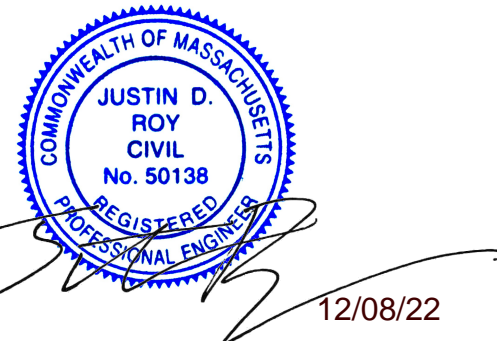
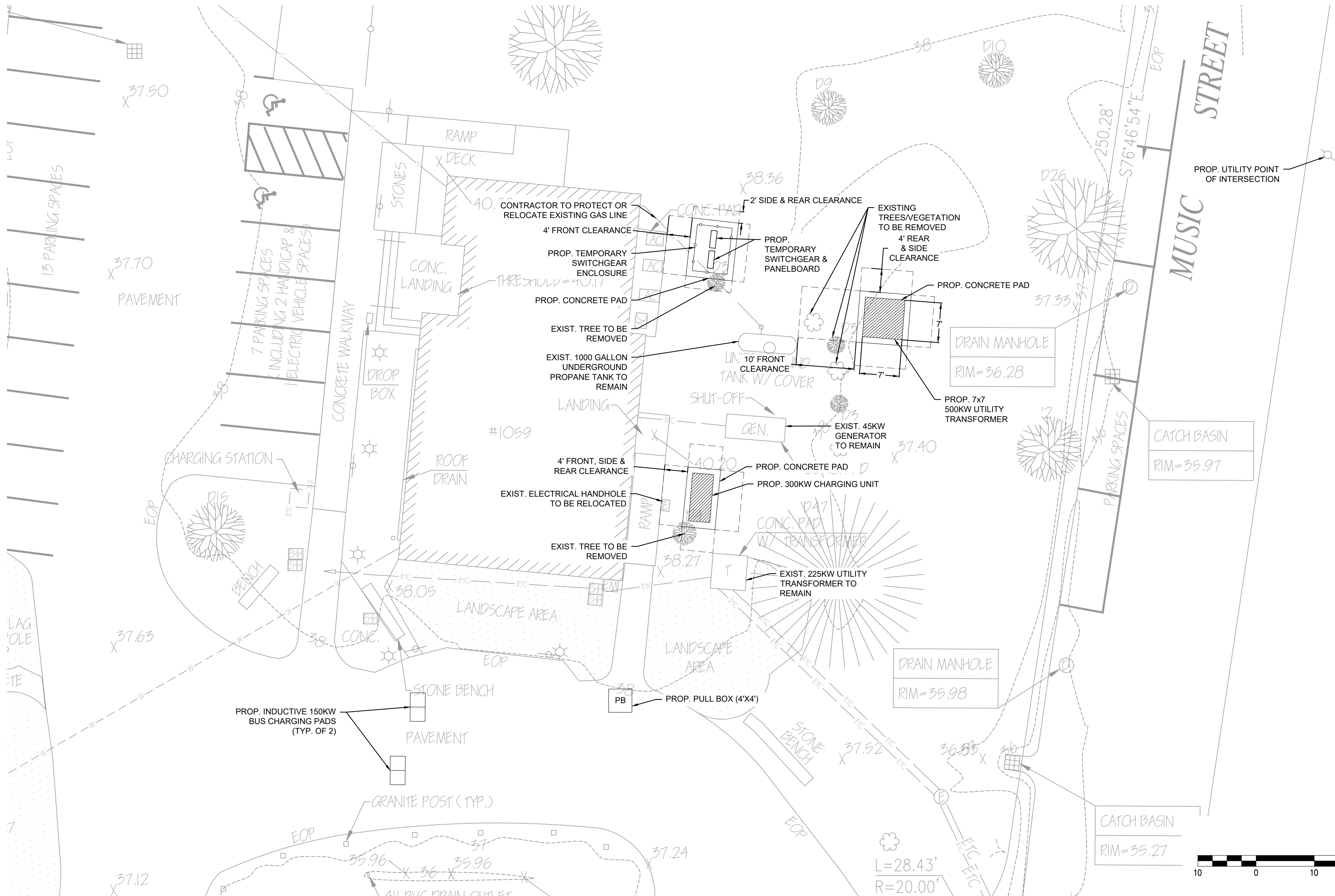

Engineer Stamp

Revisions		
ISSUE	DATE	DESCRIPTION
0	11/4/2022	SCHEMATIC DESIGN
1	12/7/2022	SCHEMATIC DESIGN UPDATE

ARUP

60 State Street
Boston, MA 02109
T +1 617 864 2987 F +1 617 864 6178
www.arup.com

Client
MARTHA'S VINEYARD
TRANSIT AUTHORITY

Job Title
WEST TISBURY TOWN HALL

NOT FOR
CONSTRUCTION

Drawing Title
TEMPORARY SITE LAYOUT

Scale	1" = 10'
Date	12/7/2022
Drawing Status	SCHEMATIC DESIGN
Job No	265773-00
Sheet No.	C2.001
Issue	1

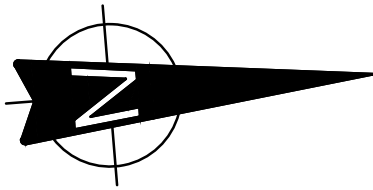

REGULATORY NOTES

- CONTRACTOR SHALL CONTACT DIG-SAFE FOR UNDERGROUND UTILITY MARKING AT 1-888-344-7233 AT LEAST 72 HOURS PRIOR TO COMMENCEMENT OF ANY WORK.
- THE CONTRACTOR SHALL BE RESPONSIBLE FOR PROPERLY LOCATING AND COORDINATING ANY ON-SITE ACTIVITY WITH DIG-SAFE AND THE APPROPRIATE UTILITY COMPANY AND MAINTAINING EXISTING UTILITY SYSTEM SERVICE.
- CONTRACTOR SHALL MAKE THEMSELVES AWARE OF AND SHALL COMPLY WITH ALL CONSTRUCTION REQUIREMENTS, CONDITIONS, AND LIMITATIONS IMPOSED REGULATORY REQUIREMENTS, PERMITS, AND APPROVALS OF REGULATORY AUTHORITIES AND UTILITY COMPANIES PRIOR TO COMMENCEMENT OF ANY WORK. CONTRACTOR SHALL COORDINATE AND OBTAIN ALL CONSTRUCTION PERMITS, APPROVALS, INSPECTIONS, AND/OR CERTIFICATIONS REQUIRED BY REGULATORY AUTHORITIES.
- DISPOSE OF ALL CONSTRUCTION WASTE IN ACCORDANCE WITH ALL APPLICABLE LAWS AND REGULATIONS.
- WETLAND FLAGS AND FLAG NUMBERS SHALL BE SURVEYED, RE-FLAGGED IF NECESSARY, AND SHALL REMAIN IN PLACE FOR THE DURATION OF THE PROJECT. DAMAGED OR DESTROYED FLAGS SHALL BE REPLACED AND THEIR LOCATIONS INSPECTED BY A CONSERVATION COMMISSION REPRESENTATIVE. THE METHOD BY WHICH MISSING FLAGS ARE LOCATED SHALL BE SUBJECT TO THE APPROVAL OF THE COMMISSION.
- ANY DISCHARGE FROM DEWATERING OPERATIONS, SHOULD SUCH OPERATIONS PROVE NECESSARY, SHALL TAKE PLACE OUTSIDE THE 100-FOOT BUFFER ZONE TO WETLAND RESOURCE AREAS AND WITHIN THE LIMIT OF WORK. DISCHARGE FROM SEDIMENTATION BASINS SHALL BE FILTERED THROUGH SILT SACKS.
- NO MATERIALS, INCLUDING BUT NOT LIMITED TO GRAVEL, TOPSOIL, BOULDERS, BRUSH, LOGS, STUMPS, SLASH, ASPHALT, AND CONSTRUCTION SUPPLIES OR DEBRIS, SHALL BE STORED OR BURIED WITHIN THE 100-FT BORDERING VEGETATED WETLAND BUFFER ZONE, OR THE FEMA 100-YEAR FLOOD AREA. ALL SUCH MATERIALS SHALL BE REMOVED FROM THE SITE PRIOR TO COMPLETION OF THE PROJECT, EXCEPT AS APPROVED BY THE OWNER'S REPRESENTATIVE.

GENERAL NOTES

- TOPOGRAPHIC/SITE SURVEY AND LOCATIONS OF UNDERGROUND UTILITIES SOURCED FROM "EXISTING CONDITIONS" BY FARLAND CORP., DATED SEPTEMBER 30, 2022.
- EXISTING UNDERGROUND ELECTRICAL UTILITY ALIGNMENT FROM GENERATOR TO WEST TISBURY TOWN HALL (WTHH) BASED ON SITE PHOTOGRAPHY TAKEN BY WTHH STAFF ON OCTOBER 12, 2022.
- VERTICAL ELEVATIONS REFER TO THE NORTH AMERICAN VERTICAL DATUM OF 1998 (NAVD 88) AND HORIZONTAL LOCATIONS REFER TO THE NORTH AMERICAN DATUM OF 1983 (NAD 83).
- ARUP HAS NOT VERIFIED EXISTING CONDITIONS INFORMATION INDICATED HEREON. LOCATIONS OF EXISTING UNDERGROUND UTILITIES/OBSTRUCTIONS/STRUCTURES/SYSTEMS SHOWN HEREON ARE APPROXIMATE ONLY. ADDITIONAL UTILITIES/OBSTRUCTIONS/STRUCTURES/SYSTEMS NOT INDICATED HEREON MAY EXIST. EXISTING UTILITY, PROPERTY LINE, AND ENVIRONMENTAL RESOURCE AREA INFORMATION INDICATED ON THIS PLAN SHOULD BE CONSIDERED APPROXIMATE.
- NO GUARANTEE IS IMPLIED OR INTENDED AS TO THE ACCURACY, LOCATION, OR THAT ALL UTILITIES AND/OR SUBSURFACE STRUCTURES ARE SHOWN. CONTRACTOR SHALL VERIFY SIZE, LOCATION, AND ELEVATIONS OF UTILITIES AND STRUCTURES AS REQUIRED PRIOR TO THE START OF ANY CONSTRUCTION.
- EXISTING UTILITIES TO REMAIN AND BE PROTECTED DURING CONSTRUCTION UNLESS OTHERWISE NOTED. CONTRACTOR TO NOTIFY ENGINEER ABOUT ANY CONFLICTS.
- THE CONTRACTOR SHALL BE RESPONSIBLE FOR PROPERLY LOCATING AND COORDINATING ANY ON-SITE ACTIVITY WITH DIG-SAFE AND THE APPROPRIATE UTILITY COMPANY AND MAINTAINING EXISTING UTILITY SYSTEM SERVICE.
- SAFETY MEASURES, CONSTRUCTION METHODS AND CONTROL OF WORK SHALL BE RESPONSIBILITY OF CONTRACTOR.
- CONTRACTOR SHALL BE RESPONSIBLE FOR REPAIR AND/OR REPLACEMENT OF ANY EXISTING IMPROVEMENTS DAMAGED DURING DEMOLITION THAT ARE NOT DESIGNATED FOR DEMOLITION AND/OR REMOVAL ON THE CONTRACT DOCUMENTS. DAMAGED IMPROVEMENTS SHALL BE REPAIRED TO THE SATISFACTION OF THEIR RESPECTIVE OWNERS.
- ALL DISTURBED AREAS SHALL BE RESTORED TO THEIR PRE-CONSTRUCTION CONDITIONS UPON COMPLETION OF DEMOLITION WORK, UNLESS OTHERWISE NOTED ON THE CONTRACT DOCUMENTS.
- ANY DEMOLITION NECESSITATED BY FIELD CONDITIONS NOT COVERED ON THE CONTRACT DOCUMENTS SHALL BE REVIEWED AND APPROVED BY THE OWNER'S REPRESENTATIVE PRIOR TO IMPLEMENTATION.
- CONTRACTOR SHALL PROVIDE EROSION AND SEDIMENTATION CONTROL AS NEEDED TO PREVENT TRANSPORT OF SEDIMENT FROM THE WORK SITE TO PAVED SURFACES, STORM SEWERS, AND WETLANDS IN THE AREA WHETHER OR NOT SHOWN HEREON. ANY SEDIMENT TRACKED FROM THE WORK SITE ONTO PAVED SURFACES SHALL BE REMOVED BY THE CONTRACTOR AT THE END OF EACH WORK DAY.

- CONTRACTOR SHALL IDENTIFY AND PROVIDE SILTATION PROTECTION FOR ALL CATCH BASINS DOWNGRADIENT OF THE PROJECT LIMIT OF WORK.
- CONTRACTOR TO PROTECT TREES FROM DAMAGE DURING CONSTRUCTION. FOR EXCAVATIONS WITHIN THE DRIP LINE OF TREES:
 - DO NOT CUT ROOTS OVER 1 INCH IN DIAMETER WITHOUT APPROVAL OF THE ENGINEER.
 - PROTECT EXPOSED ROOTS OVER 1 INCH IN DIAMETER WITH DRY SACKING DURING EXCAVATION. REMOVE DRY SACKING BEFORE BACKFILLING, AND COMPACT BACKFILL WITH CARE AROUND THE RETAINED ROOTS.
 - PRUNE ROOTS WHICH HAVE TO BE REMOVED USING A SHARP TOOL; MAKE A CLEAN CUT AND LEAVE AS SMALL A WOUND AS POSSIBLE.
- DO NOT STORE MATERIALS, EQUIPMENT, OR STOCKPILE SOIL WITHIN THE DRIP LINE OF TREES.
- PROTECT IN PLACE OR REMOVE AND REINSTATE EXISTING WAYFINDING AND PARKING SIGNS (NOT SHOWN HEREON). COORDINATE WITH OWNERS REPRESENTATIVE.
- CONTRACTOR TO PROVIDE TEMPORARY CONSTRUCTION FENCING AND SIGNAGE. SUBMIT CONSTRUCTION PHASING, FENCING, AND SIGNAGE PLAN FOR APPROVAL.
- PROPOSED SAWCUT AREA INDICATES ANTICIPATED SURFACE REMOVAL EXTENTS. MINIMIZE REMOVAL OF EXISTING SURFACES DURING DEMOLITION AND CONSTRUCTION AND REINSTATE ALL EXISTING SURFACES IN KIND UNLESS OTHERWISE NOTED.
 - PROPOSED IMPERVIOUS COVERAGE NOT TO EXCEED EXISTING CONDITIONS. IF PROPOSED IMPERVIOUS COVERAGE EXCEEDS EXISTING CONDITIONS, ADDITIONAL PERMITTING/APPROVAL AND STORMWATER DESIGN MAY BE REQUIRED.
- MATCH EXISTING GRADING TO MAXIMUM EXTENT PRACTICABLE AND MAINTAIN EXISTING DRAINAGE PATTERNS. THE PROPOSED WORK SHALL NOT CREATE ANY NEW LOW POINTS ON THE SITE.
- REFER TO ELECTRICAL DRAWINGS AND SPECIFICATIONS FOR ADDITIONAL REQUIREMENTS.
- COORDINATE ALL WORK WITH ELECTRICAL CONTRACTOR AND UTILITY COMPANY.

PROPOSED WORKS LEGEND

- ELECTRICAL EQUIPMENT AND CONCRETE PAD
- EQUIPMENT CLEARANCE
- INDUCTIVE BUS CHARGING PADS
- PULL BOX

EXISTING WORKS LEGEND

- PROPERTY LINE
- CONTOUR LINE
- EXISTING EDGE OF PAVEMENT
- EXISTING WATER LINE
- EXISTING GAS LINE
- EXISTING ELECTRICAL, TELEPHONE, & CABLE
- EXISTING GRAVITY SEWER
- CHAIN LINK FENCE
- WOOD FENCE
- POST AND RAIL FENCE
- WATER GATE
- SIGN
- LIGHT
- UTILITY POLE
- CATCH BASIN
- DRAIN MANHOLE
- ELECTRIC MANHOLE
- ELECTRIC HANDHOLE
- ELECTRIC METER
- ELECTRIC BOX
- TRANSFORMER
- BUSH
- EVERGREEN TREE (DIAMETER IN INCHES)
- DECIDUOUS TREE (DIAMETER IN INCHES)

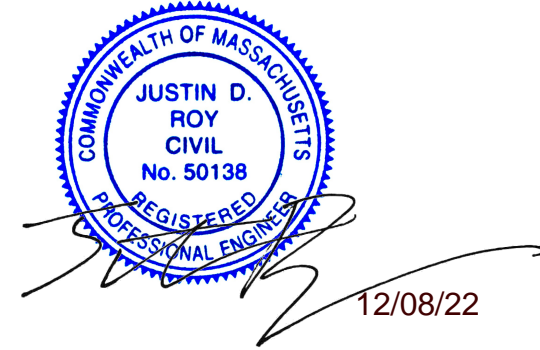
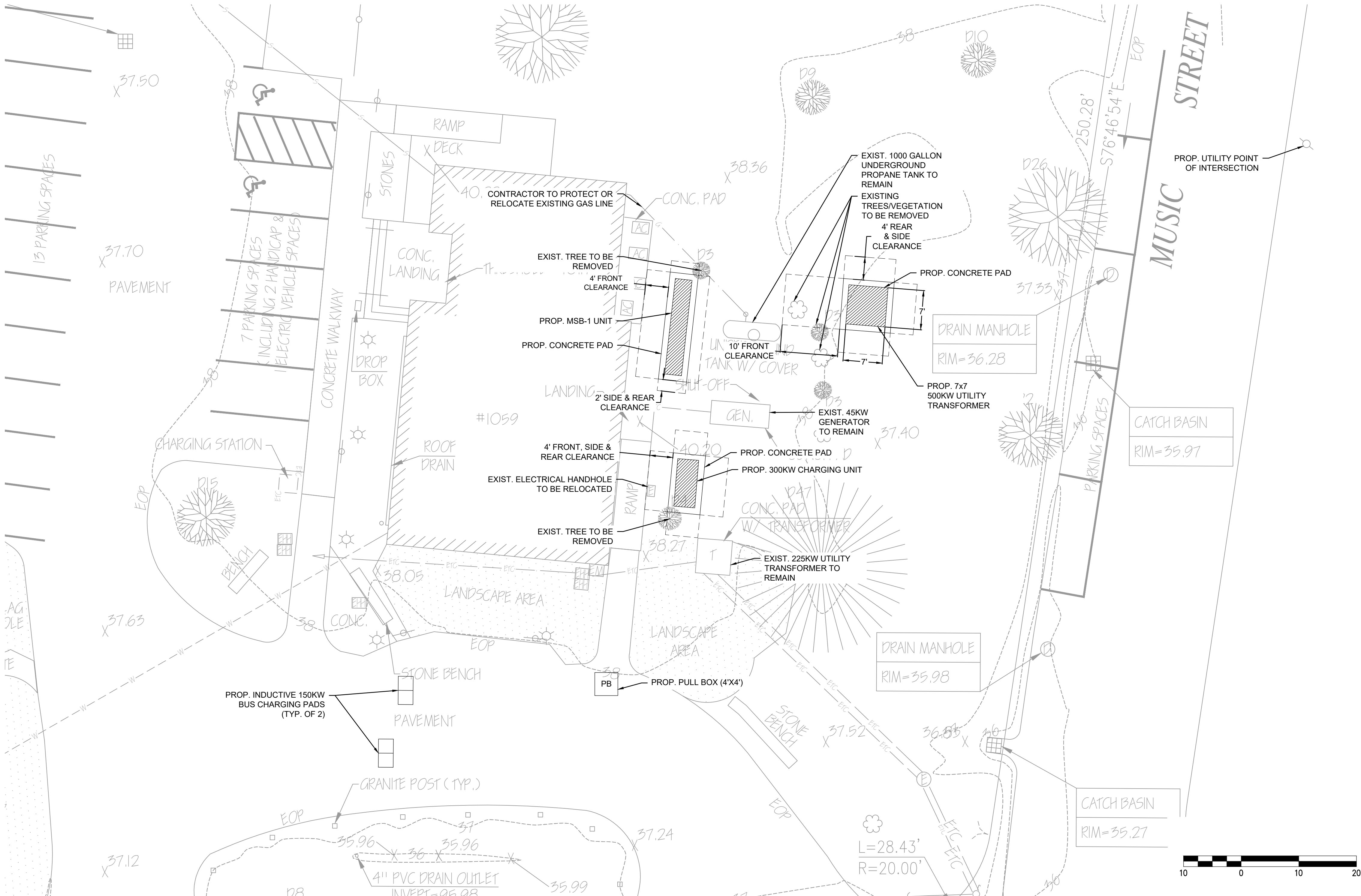

Engineer Stamp

Revisions		
ISSUE	DATE	DESCRIPTION
0	11/4/2022	SCHEMATIC DESIGN
1	12/7/2022	SCHEMATIC DESIGN UPDATE

ARUP

60 State Street
Boston, MA 02109
T +1 617 864 2987 F +1 617 864 6178
www.arup.com

Client
MARTHA'S VINEYARD
TRANSIT AUTHORITY

Job Title
WEST TISBURY TOWN HALL

NOT FOR
CONSTRUCTION

Drawing Title
PERMANENT SITE LAYOUT

Scale
1" = 10'

Date
12/7/2022

Drawing Status
SCHEMATIC DESIGN

Job No 265773-00	Sheet No C2.000	Issue 1
---------------------	--------------------	------------